

# STATU RE

SOUTHBANK

**SALVO** PROPERTY  
GROUP

# THE BEST OF MELBOURNE AT YOUR FRONT DOOR

Standing tall in Melbourne's coveted Southbank, Stature is a building connected to the very best of the city. Form and function together with spectacular views in all directions unite to bring a distinguished new landmark to this vibrant lifestyle precinct. A diverse array of exclusive amenities will provide residents with peerless resort style living, creating a prestigious lifestyle beyond the walls of the stylish homes.

Crafted by the award winning team of Salvo Property and Squillace Architects, Stature with an already award winning design added to its name is sure to become a highly sought after Southbank address.





DOCKLANDS  
BUSINESS  
PRECINCT

MELBOURNE  
CONVENTION &  
EXHIBITION CENTRE

YARRA RIVER

SOUTHERN  
CROSS STATION

CROWNE  
PLAZA

CROWN  
ENTERTAINMENT  
COMPLEX

RIALTO  
TOWERS

SEA LIFE  
AQUARIUM

MELBOURNE  
CBD

CROWN  
METROPOL

SOUTHBANK  
PROMENADE

FLINDERS ST  
STATION

EUREKA  
TOWER

STATURE  
SOUTH BANK

TO WEST GATE FREEWAY  
TO WEST GATE BRIDGE

TO SOUTH MELBOURNE  
SHOPPING PRECINCT

TO ARTS PRECINCT





# SOUTHBANK. ONE OF MELBOURNE'S PREMIER LIFESTYLE PRECINCTS.



LOCATION  
STATURE | SOUTHBANK





TEEMING WITH CULTURAL SITES, LUXURY  
BOUTIQUES AND LIVELY PROMENADES,  
SOUTHBANK DISTILS MELBOURNE'S FINEST  
ATTRIBUTES INTO ONE SPECTACULAR PRECINCT.



LOCATION  
STATURE | SOUTHBANK





■  
**Coventry St,**  
South Melbourne



■  
**Regents Theatre,**  
Collins St, Melbourne



[illegible]

1.	Crown Complex	10.	Federation Square
2.	Palladium At Crown	11.	Arts Centre
3.	Melbourne Convention and Exhibition Centre	12.	National Gallery of Victoria
4.	Southern Cross Station	13.	The Shrine Of Remembrance
5.	Marvel Stadium	14.	Margaret Court Arena
6.	Rialto Towers	15.	Rod Laver Arena
7.	Eureka Tower	16.	Melbourne Hisense Arena
8.	Flinders Station	17.	AAMI Stadium
9.	St Pauls Cathedral	18.	Melbourne Cricket Ground (MCG)

1. Commonwealth Bank HQ
2. Alibaba HQ
3. ANZ Docklands
4. NAB Docklands
5. Exxon Mobil
6. PwC Melbourne
7. BHP Melbourne
8. EY Melbourne
9. Telstra Corporate Head Office
10. AustralianSuper

1. South Melbourne Primary School
2. South Melbourne Mission Kindergarten
3. Albert Park Primary School
4. South Melbourne Park Primary School
5. The Mac.Robertson Girls' High School
6. University of Melbourne,  
Southbank Campus
7. Victoria University
8. La Trobe University City Campus

1. Albert Park Lake
2. Fawknor Park
3. Royal Botanic Gardens
4. Kings Domain
5. Alexandra Gardens
6. Goschs Paddock
7. Fitzroy Gardens
8. Flagstaff Gardens

1. Chez Dre
2. St. Ali Coffee Roasters
3. Pietro e Paolo
4. Kettle Black
5. Grain Store
6. Higher Ground
7. Operator 25

1. The Boatbuilders Yard
2. Whitehart Bar
3. Arbory Bar
4. Boilermaker House
5. Garden State Hotel
6. 1806
7. Siglo

1. Melbourne Central
2. Myer Department Store
3. Bourke St Mall
4. David Jones Department Store
5. St. Collins Lane
6. South Melbourne Market





## DINING

Indulge in the endless dining options in Southbank, home of Melbourne's premier cafés and restaurants, with all the cosmopolitan tastes and cuisines of the city just moments away.

## PRESTIGE SHOPPING

Southbank promenade is home to an extensive mix of premium boutiques from local and international designers and has become a destination for high end shopping. In the CBD, Collins Street has long been viewed as the home of luxury retail, with flagship stores from Louis Vuitton, Hermes and more, lining the street.

## ARTS & CULTURE

Relish in the flourishing arts & culture scene Melbourne is renowned for. The Arts Precinct, home to the National Gallery of Victoria, The Arts Centre and a host of other theatres and galleries, is just a short stroll from Stature along the Southbank promenade.

## BARS

Melbourne comes alive at night. With intimate bars, luxurious nightclubs and the Crown Entertainment complex, there is no shortage of venues to relax and enjoy the evenings.





■  
Albert Park Lake,  
Melbourne



■  
Queen Victoria Gardens,  
Linlithgow Ave, Melbourne





Bourke St Mall,  
Bourke St, Melbourne



South Melbourne Market,  
South Melbourne



Alexandra Gardens,  
Boathouse Dr, Melbourne



Yarra River,  
Melbourne

## ICONIC MELBOURNE

A city full of history, culture life, Melbourne's CBD is only steps away from Stature. From the iconic laneways and hidden arcades to landmarks like Federation Square and Bourke Street Mall, there is something unique and captivating around every corner.

## FRESH FOOD AND PRODUCE

Stature is ideally located near the iconic South Melbourne Markets, where residents will find locally sourced produce within its historic stalls. The market is an institution in the area, attracting visitors from far and wide.

## PARKS & GARDEN

There's a good reason Victoria is known as the Garden State. Spectacular parks like the Royal Botanic Gardens and Alexandra Gardens define the inner city landscape providing residents with beautiful venues to enjoy the outdoors.

## YARRA RIVER

The soul of the city, the Yarra River and its trails stretch through Southbank, inviting residents on morning runs and afternoon strolls.





Artist Impression

# STATURE. AT HOME HIGH ABOVE THE CITY.

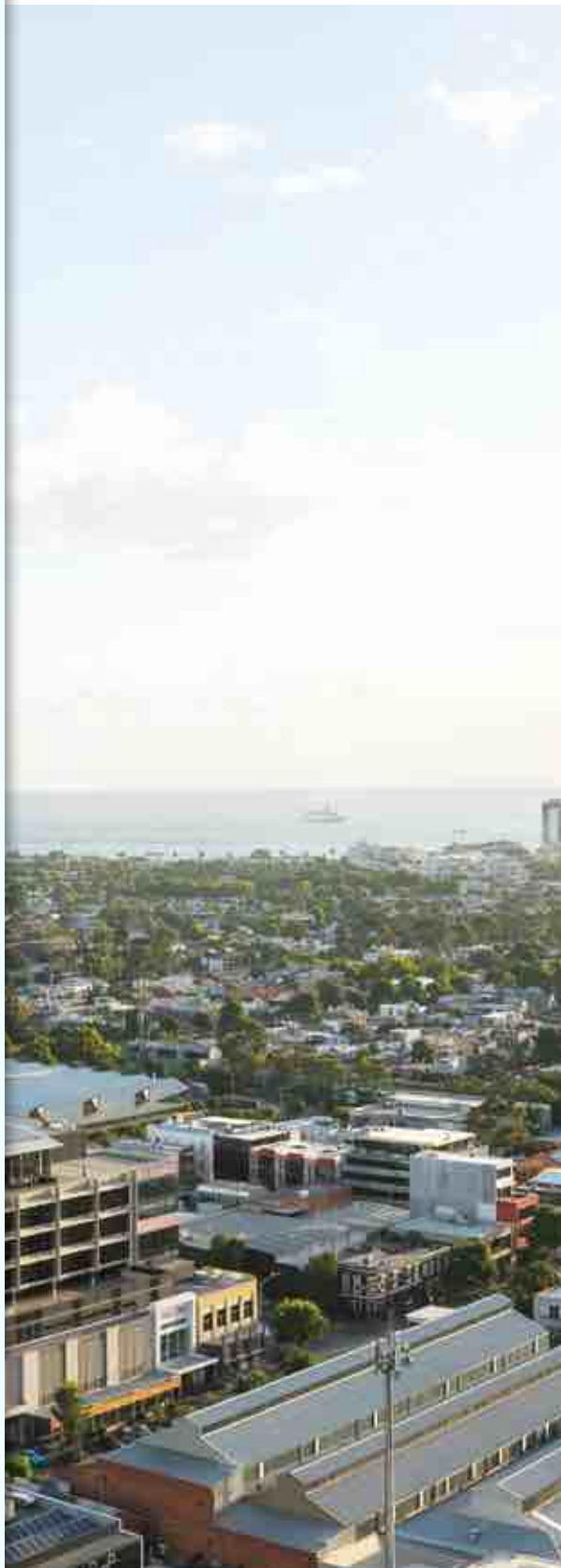



**A SHINING BEACON IN THE MELBOURNE  
SKY, STATURE'S IMPECCABLE  
ARCHITECTURE GIVES WAY TO EXPANSIVE  
VIEWS ACROSS THE ENTIRE CITY.**



Artist Impression





WELCOMING ITS RESIDENTS HOME EACH  
DAY, STATURE'S ARTFULLY DESIGNED  
ENTRANCE IS SLEEK AND MODERN WITH  
AN UNDERSTATED ELEGANCE.

Artist Impression





Artist Impression

**STREET  
ACTIVATION  
WILL BRING  
SOUTHBANK  
PROMENADE  
TO YOUR  
FRONT DOOR.**



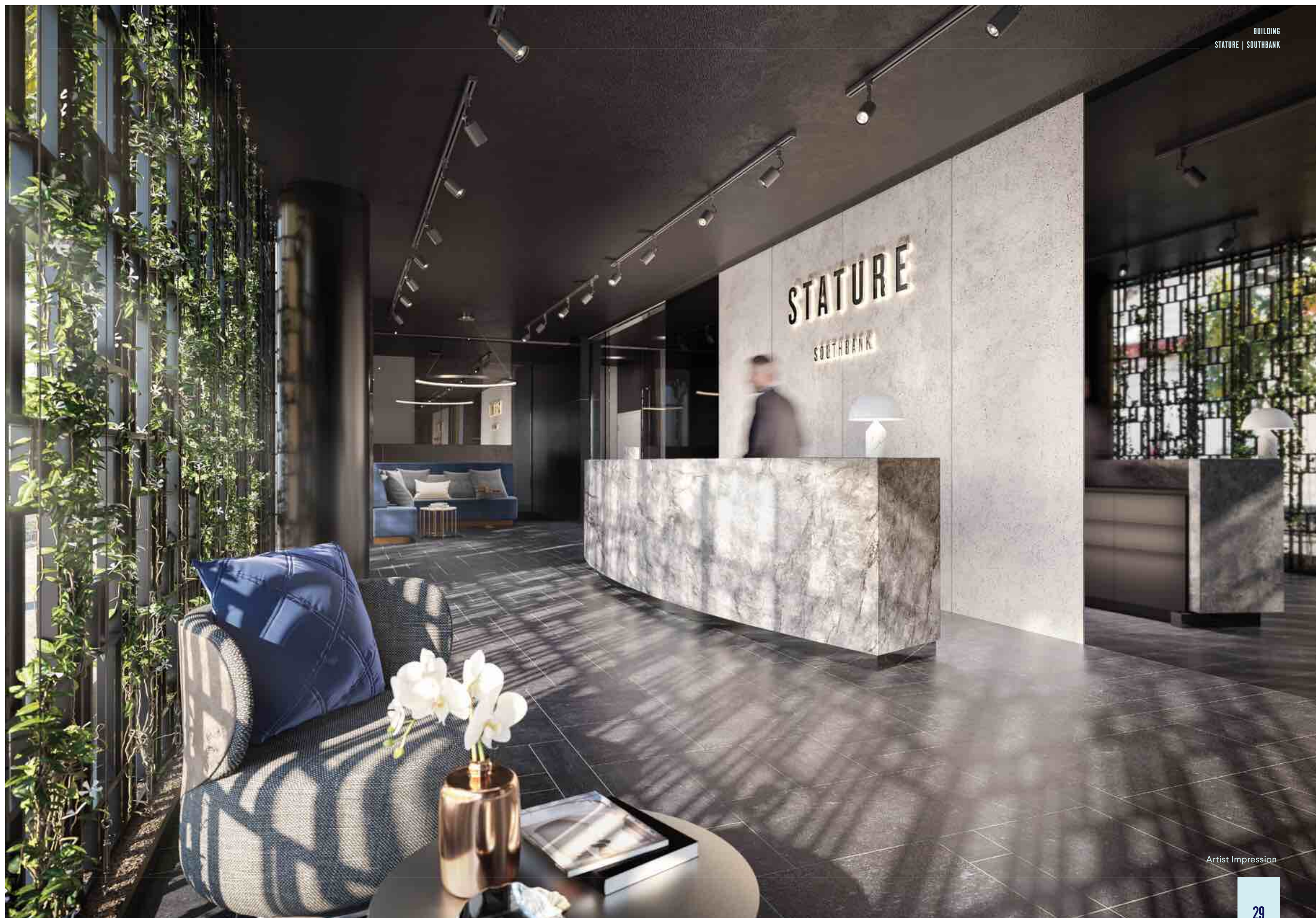

Artist Impression



**HIGH ABOVE THE CITY, RESIDENTS  
CAN RELAX AT A RESORT-QUALITY  
POOL WHILE TAKING IN SPRAWLING  
VIEWS OF MELBOURNE.**

Day or night, the private resident amenities at Stature provide the ideal environments to unwind by yourself or spend a little quality time with friends.

Artist Impression



RESIDENTS OF STATURE HAVE EXCLUSIVE ACCESS  
TO THE BEAUTIFUL, COMMUNAL LOUNGE, BOASTING  
FLAWLESS INTERIOR STYLING AND IDEAL SPACES  
FOR ENTERTAINING.

Artist Impression





# ENJOY EVERY SUNSET FROM THE STUNNING ROOFTOP GARDEN.

Featuring beautifully designed spaces, defined by lush, green planting, Stature's rooftop garden makes the most of its elevated location, providing views that are second to none.



**BOLD LINES  
AND EXPANSES  
OF GLASS DEFINE  
STATURE'S  
STRIKING FACADE.**

BUILDING  
STATURE | SOUTHBANK

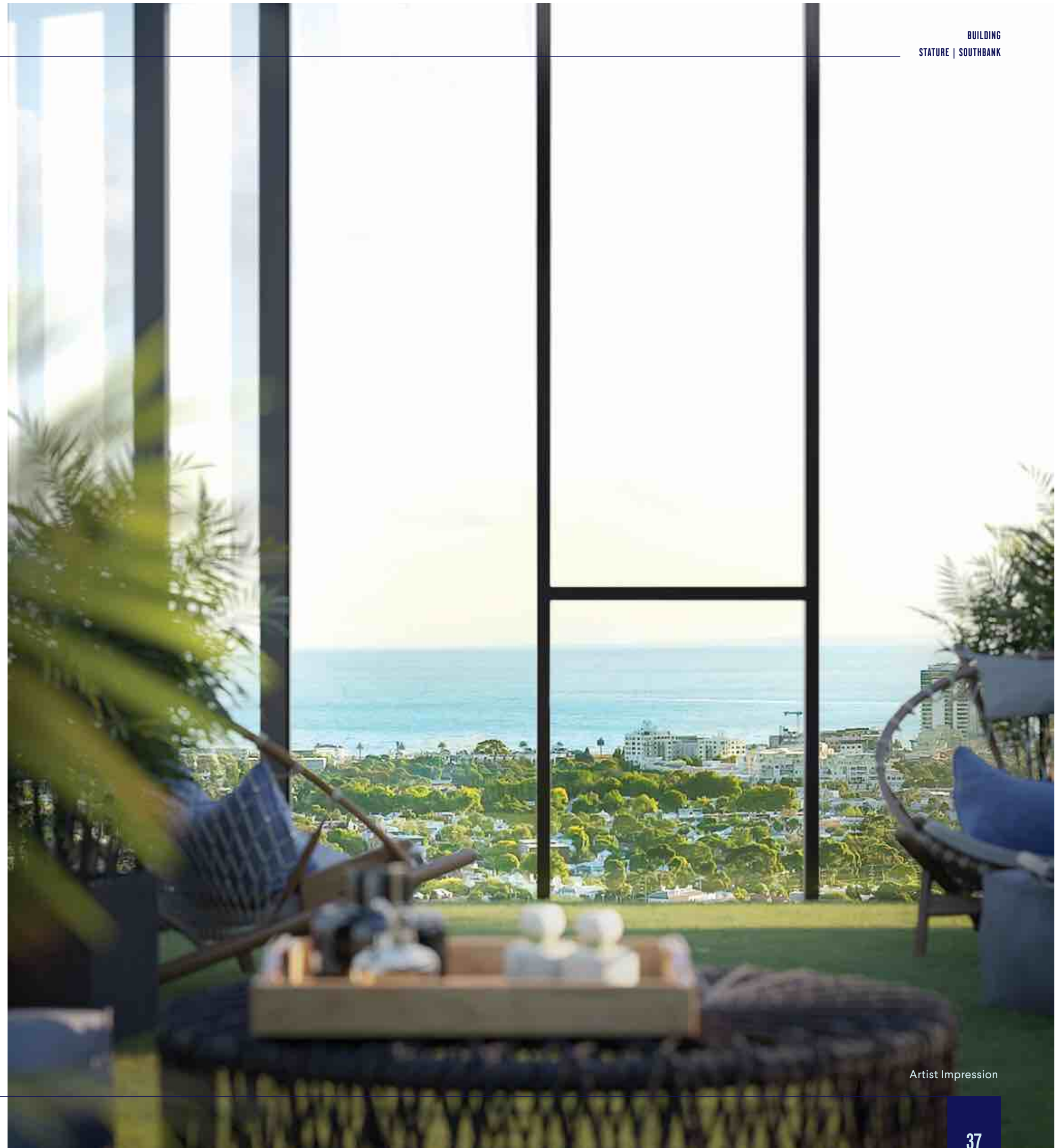

Artist Impression





Oak Scheme | Artist Impression

# TIMELESS STYLE FOR MODERN LIVING.





**PREMIUM FINISHES AND EXCEPTIONAL  
DESIGN FLOWS THROUGH EACH AND EVERY  
RESIDENCE AT STATURE.**



Oak Scheme | Artist Impression







Oak Scheme | Artist Impression

**WAKE UP TO  
MORE THAN  
YOU DARE  
DREAM.**





In the living room, timber flooring and a neutral colour palette with bold, black accents create a stylish, minimalist aesthetic. Expansive windows take advantage of the picturesque outlook, while also allowing ample natural light to flood the space.

Oak Scheme | Artist Impression





Oak Scheme | Artist Impression

**CONSIDERED DESIGN  
& MATERIALS,  
ENSURE EVERY  
RESIDENCE IS  
STEEPED IN QUALITY  
AND FUNCTIONALITY.**



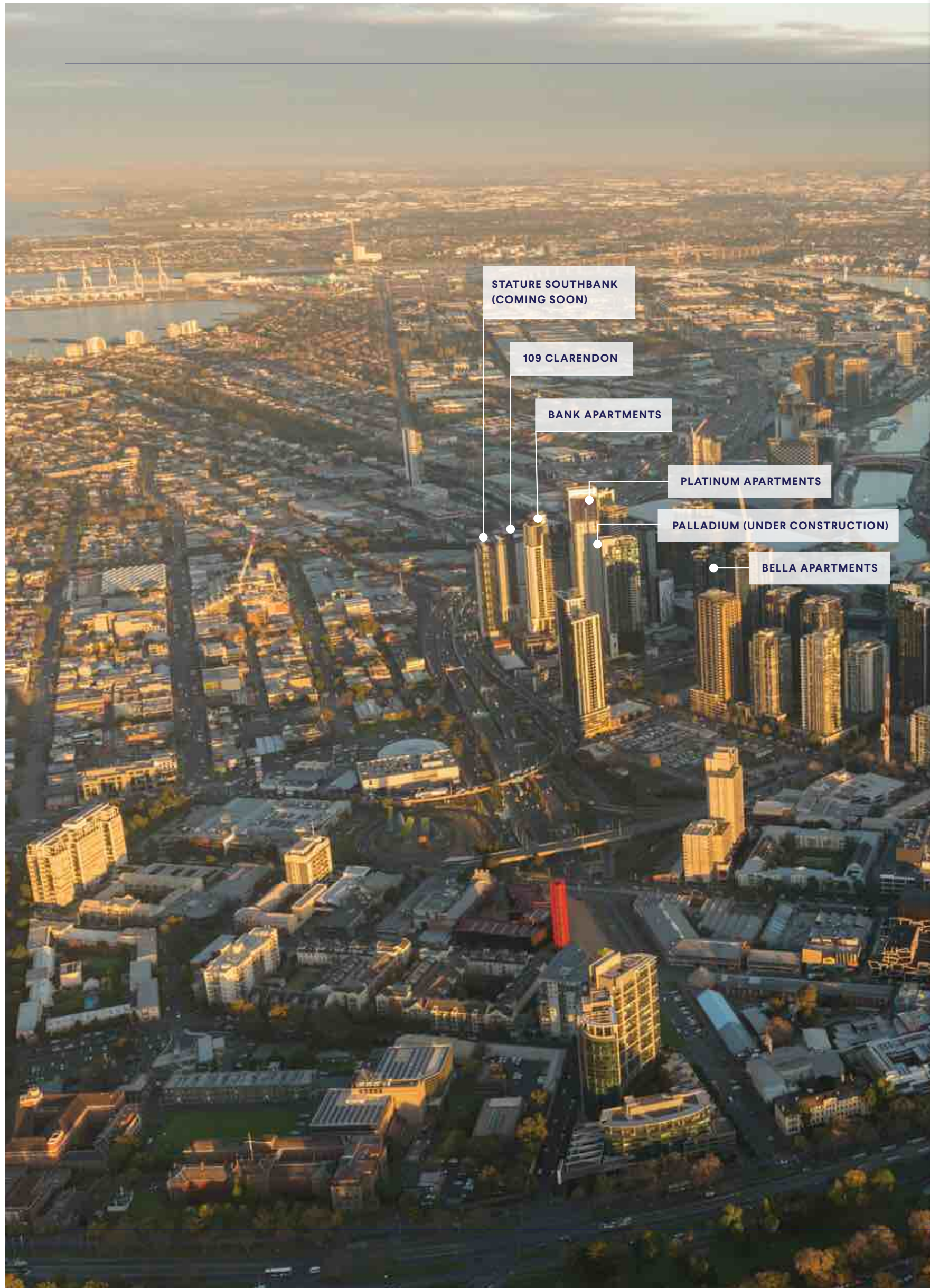

# SALVO & SOUTHBANK. A SHARED HISTORY.







**SALVO PROPERTY GROUP HAS CRAFTED  
SOUTHBANK'S SKYLINE, WITH FIVE  
ESTABLISHED, LANDMARK BUILDINGS,  
SOON TO BE JOINED BY STATURE.**



**SALVO & SOUTHBANK  
STATURE | SOUTHBANK**





# MARIO SALVO

For over two decades, Salvo Property Group and the Southbank precinct have been entwined. Through creating quality residential projects in key locations within the area, we were not only building our reputation as a leading Melbourne property developer, we were also contributing to the evolution of Southbank as a lifestyle destination.

Salvo Property Group along with our collaborators Squillace Architects are the winners of 2019 - 2020 Asian Pacific Property Awards in the Residential High Rise category. No matter how times have changed, our commitment to delivering quality residential property with award winning design in Southbank remains unchanged. Stature Southbank is our latest venture, created in partnership with our frequent collaborators, Squillace Architects. Offering the type of timeless, resort style living that has become our hallmark, Stature will undoubtedly become another landmark in the Melbourne skyline.

A lasting reminder of our commitment to celebrating Southbank, as one of the city's most dynamic and vibrant lifestyle precincts.

*Mario Salvo*

## POPULATION GROWTH



The 2019 population forecast for Southbank is 24,801, and is forecast to grow to 53,288 by 2041.

## LIVEABILITY



According to the Economist Intelligence Unit, education, infrastructure, culture are some factors that make Melbourne one of the most liveable cities in the world. It currently ranks number 2 in the top 5 most liveable cities.

## 1ST CLASS AMENITIES

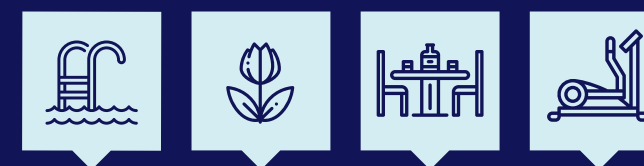

Stature Southbank offers its residents hundreds of square metres of facilities including the pool, gym as well as the rooftop garden and communal dining area.

## LOCATION



A near perfect walk score means Stature Southbank is perfectly positioned amongst the exciting hustle and bustle of the city, minutes from Melbourne's CBD.

## TRUSTED DEVELOPER



Salvo Property Group has delivered over 3300 luxury apartments as well as several commercial projects over the last 10 years worth a combined \$2billion.

## SALVO PROPERTY GROUP



Winner at 2019 - 2020 Asia Pacific Property Awards - Residential High Rise Category.



# COLLABORATORS



Salvo Property Group is a leading real estate developer and manager, committed to creating affordable luxury apartments in quality landmark buildings that add an exciting feel to the promenades of Australia's thriving capital cities and neighbourhood centres. Over the past decade we have delivered in excess of 3,000 apartments worth more than \$1.5 billion to our customers.



Over the last 21 years, Squillace Architects have developed a reputation for creating design-driven responses across all types of property. Our approach focuses on the holistic practice of architecture, incorporating a dynamic design aesthetic with a fundamental understanding of commercial realities, culminating in results that consistently exceed expectations.

# WWW.STATURESOUTHBANK.COM.AU

The information contained in this brochure has been provided from reliable sources and is intended to be as accurate as possible. The Developer however makes no guarantee, warranty or representation as to the accuracy of the information provided in the brochure and it should not be relied upon. It is the consumer's or purchaser's responsibility to independently confirm the accuracy and completeness of the information provided and to enter into and negotiate contracts of sale for the purchase of an apartment which will be the legally binding document between the parties. All images, views and diagrams are indicative or artists impressions only. Dimensions, areas, fittings, specifications, tiling, paving and floor finishes, landscape and paved areas are indicative and subject to change without notice. Furniture and Whitegoods are also indicative only and not included in the prices disclosed unless specifically indicated elsewhere in the Contract of Sale. Any floor areas estimated are based on the Property Council of Australia method of measurement guidelines and indicative only and should not be relied upon as the actual size or floor area of any apartment purchased. Purchasers should check the plans, specifications and goods included in the terms of the contract of sale carefully prior to signing any contract of sale.



